

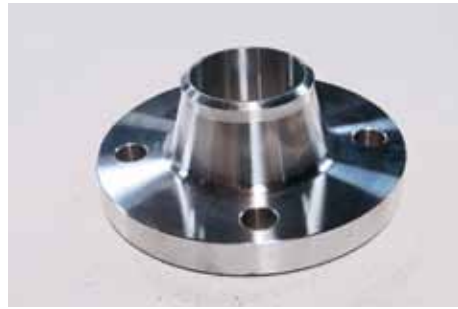

ACCESORIOS

Bidas



BRIDA WELDING NECK 150



BRIDA SLIP ON 150



BRIDA CIEGA 150

DIMENSIONES DE ESPÁRRAGOS PARA BRIDAS

BRIDA	CLASE 150	CLASE 300	CLASE 600
MEDIDA	RF 1,6 mm	RF 1,6 mm	RF 6,4 mm
1/2"	1/2" x 2 1/2"	1/2" x 2 3/4"	1/2" x 3 1/4"
3/4"	1/2" x 2 1/2"	5/8" x 3"	5/8" x 3 1/2"
1"	1/2" x 2 3/4"	5/8" x 3 1/4"	5/8" x 3 3/4"
1 1/4"	1/2" x 2 3/4"	5/8" x 3 1/4"	5/8" x 4"
1 1/2"	1/2" x 3"	3/4" x 3 1/2"	3/4" x 4 1/4"
2"	5/8" x 3 1/4"	5/8" x 3 1/2"	5/8" x 4 1/4"
2 1/2"	5/8" x 3 1/2"	3/4" x 4"	3/4" x 4 3/4"
3"	5/8" x 3 3/4"	3/4" x 4 1/4"	3/4" x 5"
3 1/2"	5/8" x 3 3/4"	3/4" x 4 1/2"	7/8" x 5 1/2"
4"	5/8" x 3 3/4"	3/4" x 4 1/2"	7/8" x 5 3/4"
5"	3/4" x 4"	3/4" x 4 3/4"	1" x 6 1/2"
6"	3/4" x 4"	3/4" x 5"	1" x 6 3/4"
8"	3/4" x 4 1/4"	7/8" x 5 1/2"	1 1/8" x 7 3/4"
10"	7/8" x 4 3/4"	1" x 6 1/4"	1 1/4" x 8 1/2"
12"	7/8" x 4 3/4"	1 1/8" x 6 3/4"	1 1/4" x 8 3/4"
14"	1" x 5 1/4"	1 1/8" x 7"	1 3/8" x 9 1/4"
16"	1" x 5 1/2"	1 1/4" x 7 1/2"	1 1/2" x 10"
18"	1 1/8" x 6"	1 1/4" x 7 3/4"	1 5/8" x 10 3/4"
20"	1 1/8" x 6 1/4"	1 1/4" x 8 1/4"	1 5/8" x 11 1/2"
24"	1 1/8" x 7"	1 1/2" x 9 1/4"	1 7/8" x 13"

Accesorios - Bridas Clase 150

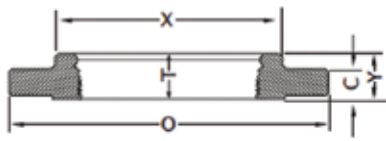

BRIDA ROSCADA

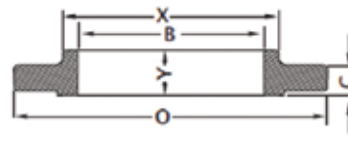

BRIDA CON CUBO PARA SOLDAR

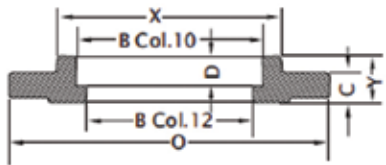

BRIDA PARA SOLDAR A ENCHUFE

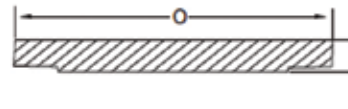

BRIDA CIEGA

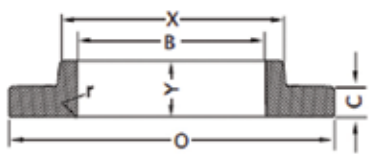

BRIDA PARA JUNTA CON SOLAPA

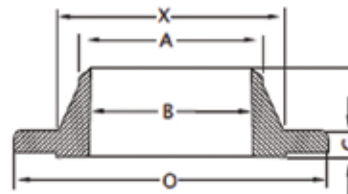

BRIDA CON CUELLO PARA SOLDAR

DIMENSIONES BRIDAS CLASE 150

1	2	3	4	5	6	7	8	9	10	11	12	13	14	15	16	17	18	
Diámetro Nominal	Diámetro Exterior O	Espesor Min. C	Diámetro del Cubo X	Diámetro del Cuello A	LONGITUD (altura total)			Longitud de Rosca T	DIÁMETRO INTERIOR				Lap Joint Min. r	Diámetro interno Q	Profundidad del Asiento D	PERFORACIONES		
					Threaded Slip on Socket Welding Y	Lap - Joint Y	Welding - Neck Y		Slip on - Socket Welding Min. B	Lap Joint Min. B	Welding - Neck Socket - Welding					Diámetro del Círculo de Agujero D	Diámetro de los Agujeros D	Cantidad de Agujeros D
											B sch.40	B sch.40						
1/2"	88,9	11,2	30,2	21,3	15,7	15,7	47,8	15,7	15,7	22,9	15,7	13,8	3,0	-	9,7	60,5	15,9	4
3/4"	98,6	12,7	38,1	26,7	15,7	15,7	52,3	15,7	15,7	28,2	20,8	18,9	3,0	-	11,2	69,9	15,9	4
1"	108,0	14,2	49,3	33,5	17,5	17,5	55,6	17,5	17,5	35,1	26,6	24,4	3,0	-	12,7	79,2	15,9	4
1 1/4"	117,5	15,7	58,8	42,2	20,6	20,6	57,2	20,6	20,6	43,7	35,0	32,6	4,8	-	14,2	88,9	15,9	4
1 1/2"	127,0	17,5	65,1	48,3	22,4	22,4	62,0	22,4	22,4	50,0	40,9	38,1	6,4	-	15,7	98,6	15,9	4
2"	152,4	19,1	77,8	60,5	25,4	25,4	63,5	25,4	25,4	62,5	52,5	49,3	7,9	-	17,5	120,7	19,1	4
2 1/2"	177,8	22,4	90,5	73,2	28,4	28,4	69,9	28,4	28,4	75,4	62,6	59,0	7,9	-	19,1	139,7	19,1	4
3"	190,5	23,9	108,0	88,9	30,2	30,2	69,9	30,2	30,2	91,4	77,9	73,7	9,7	-	20,6	152,4	19,1	4
3 1/2"	215,9	23,9	122,2	101,6	31,8	31,8	71,4	31,8	31,8	104,1	90,1	85,4	9,7	-	-	177,8	19,1	8
4"	228,6	23,9	134,9	114,3	33,3	33,3	76,2	33,3	33,3	116,8	102,3	97,1	11,2	-	-	190,5	19,1	8
5"	254,0	23,9	163,6	141,2	36,6	36,6	88,9	36,6	36,6	144,5	128,1	122,3	11,2	-	-	215,9	22,4	8
6"	279,4	25,4	192,1	168,4	39,6	39,6	88,9	39,6	39,6	171,5	154,1	146,3	12,7	-	-	241,3	22,4	8
8"	342,9	28,4	246,1	219,2	44,5	44,5	101,6	44,5	44,5	222,3	202,7	193,7	12,7	-	-	298,5	22,4	8
10"	406,4	30,2	304,8	273,1	49,3	49,3	101,6	49,3	49,3	277,4	254,4	242,9	12,7	-	-	362,0	25,4	12
12"	482,6	31,8	365,3	323,9	55,6	55,6	114,3	55,6	55,6	328,2	303,2	289,0	12,7	-	-	431,8	25,4	12
14"	533,4	35,1	400,1	355,6	57,2	79,2	127,0	57,2	57,2	360,2	Debe ser especificado por el comprador	Debe ser especificado por el comprador	12,7	-	-	476,3	28,6	12
16"	596,9	36,6	457,2	406,4	63,5	87,4	127,0	63,5	63,5	411,2			12,7	-	-	539,8	28,6	16
18"	635,0	39,6	505,0	457,2	68,3	96,8	139,7	68,3	68,3	462,3	12,7	-	-	-	-	577,9	31,8	16
20"	698,5	42,9	558,8	508,0	73,2	103,1	144,5	73,2	73,2	514,4	12,7	-	-	-	-	635,0	31,8	20
24"	812,8	47,8	663,6	609,6	82,6	111,3	152,4	82,6	82,6	616,0	12,7	-	-	-	-	749,3	35,1	20

* Las dimensiones son milimétricas.

Accesorios - Bidas Clase 300

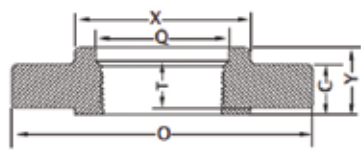

BRIDA ROSCADA

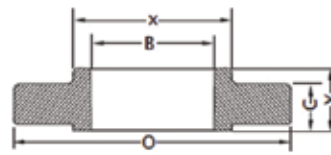

BRIDA CON CUBO PARA SOLDAR

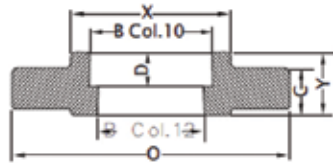

BRIDA PARA SOLDAR A ENCHUFE

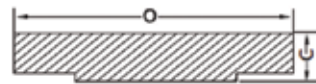

BRIDA CIEGA

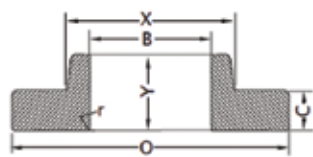

BRIDA PARA JUNTA CON SOLAPA

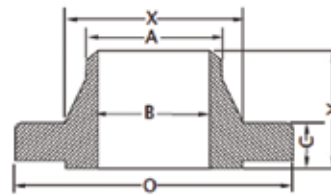

BRIDA CON CUELLO PARA SOLDAR

DIMENSIONES BRIDAS CLASE 300

1	2	3	4	5	6	7	8	9	10	11	12	13	14	15	16	17	18	
Diámetro Nominal	Diámetro Exterior O	Espesor Min. C	Diámetro del Cubo X	Diámetro del Cuello Welding - Neck A	LONGITUD (altura total)			Longitud de Rosca Threaded Min. T	DIÁMETRO INTERIOR				Radio Lap - Joint r	Diámetro interno Threaded Min. Q	Prof. del Asiento Socket - Welding D	PERFORACIONES		
					Theaded Slip on Socket Welding Y	Lap - Joint Y	Welding - Neck Y		Slip on - Socket Welding Min. B	Lap Joint Min. B	Welding - Neck Socket - Welding					Diámetro del Círculo de Agujero D	Diámetro de los Agujeros D	Cantidad de Agujeros D
											B sch.40	B sch.40						
1/2"	95,3	14,2	38,1	21,3	22,4	22,4	52,3	15,7	22,4	22,9	15,7	13,9	3,0	23,6	9,7	66,5	15,9	4
3/4"	117,5	15,7	47,8	26,7	25,4	25,4	57,2	15,7	27,7	28,2	20,8	18,9	3,0	29,0	11,2	82,9	19,1	4
1"	124,0	17,5	54,0	33,5	26,9	26,9	62,0	17,5	34,5	35,1	26,6	24,4	3,0	35,8	12,7	88,9	19,1	4
1 1/4"	133,4	19,1	63,5	42,2	26,9	26,9	65,0	20,6	43,2	43,7	35,0	32,6	4,8	44,5	14,2	98,6	19,1	4
1 1/2"	155,6	20,6	69,9	48,3	30,2	30,2	68,3	22,4	49,5	50,0	40,9	38,1	6,4	50,5	15,7	114,3	22,4	4
2"	165,1	22,4	84,1	60,5	33,3	33,3	69,9	28,4	62,0	62,5	52,5	49,3	7,9	63,5	17,5	127,0	19,1	8
2 1/2"	190,5	25,4	100,1	73,2	38,1	38,1	76,2	31,8	74,7	75,4	62,6	59,0	7,9	76,2	19,1	149,4	22,4	8
3"	209,6	28,4	117,5	88,9	42,9	42,9	79,2	31,8	90,7	91,4	77,9	73,7	9,7	92,2	20,6	168,1	22,4	8
3 1/2"	228,6	30,2	133,4	101,6	44,5	44,5	81,0	36,6	103,4	104,1	90,1	85,4	9,7	104,9	-	184,2	22,4	8
4"	254,0	31,8	146,1	114,3	47,8	47,8	85,9	36,6	116,1	116,8	102,3	97,1	11,2	117,6	-	200,2	22,4	8
5"	279,4	35,1	177,8	141,2	50,8	50,8	98,6	42,9	143,8	144,5	128,1	122,3	11,2	144,5	-	235,0	22,4	8
6"	317,5	36,6	206,4	168,4	52,3	52,3	98,6	46,0	170,7	171,5	154,1	146,3	12,7	171,5	-	269,7	22,4	12
8"	381,0	41,1	260,4	219,2	62,0	62,0	111,3	50,8	221,5	222,3	202,7	193,7	12,7	222,3	-	330,2	25,4	12
10"	444,5	47,8	320,7	273,1	66,5	95,3	117,3	55,6	276,4	277,4	254,4	242,9	12,7	276,4	-	387,4	28,6	16
12"	520,7	50,8	374,7	323,9	73,2	101,6	130,0	60,5	327,2	328,2	303,2	289,0	12,7	328,7	-	450,9	31,8	16
14"	584,2	53,8	425,5	355,6	76,2	111,3	142,7	63,5	359,2	360,2	Debe ser especificado por el comprador		12,7	360,4	-	514,4	31,8	20
16"	647,7	57,2	482,6	406,4	82,6	120,7	146,1	68,3	410,5	411,2			12,7	411,2	-	571,5	35,1	20
18"	711,2	60,5	533,4	457,2	88,9	130,0	158,8	69,9	461,8	462,3	Debe ser especificado por el comprador		12,7	462,0	-	628,7	35,1	24
20"	774,7	63,5	587,4	508,0	95,3	139,7	162,1	73,2	513,1	514,4			12,7	512,8	-	685,8	35,1	24
24"	914,4	69,9	701,7	609,6	106,4	152,4	168,1	82,6	616,0	616,0	Debe ser especificado por el comprador		12,7	614,4	-	812,8	41,3	24

*Las dimensiones son milimétricas.

Accesorios - Bridas Clase 600

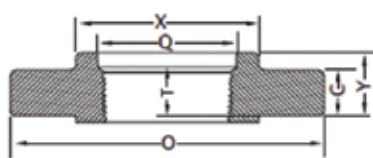

BRIDA ROSCADA

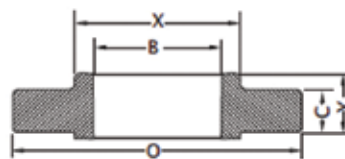

BRIDA CON CUBO PARA SOLDAR

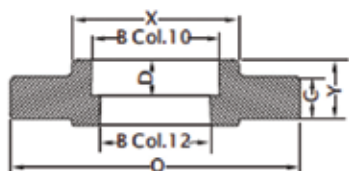

BRIDA PARA SOLDAR A ENCHUFE

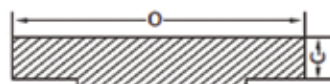

BRIDA CIEGA

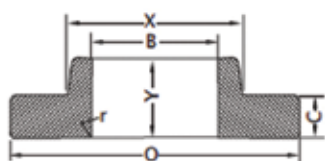

BRIDA PARA JUNTA CON SOLAPA

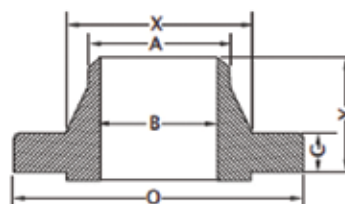

BRIDA CON CUELLO PARA SOLDAR

DIMENSIONES BRIDAS CLASE 600

1	2	3	4	5	6	7	8	9	10	11	12	13	14	15	16	17	18
Diámetro Nominal	Diámetro Exterior O	Espesor Min. C	Diámetro del Cubo X	Diámetro del Cuello A	LONGITUD (altura total)			Longitud de Rosca T	DIÁMETRO INTERIOR			Lap Joint Min. r	Diámetro interno Q	Profundidad del Asiento D	PERFORACIONES		
					Theaded Slip on Socket Welding Y	Lap - Joint Y	Welding - Neck Y		Slip on - Socket Welding Min. B	Lap Joint Min. B	Welding - Neck Socket - Welding B				Diámetro del Círculo de Agujero	Diámetro de los Agujeros	Cantidad de Agujeros
1/2"	93,5	14,2	38,1	21,3	22,4	22,4	52,3	15,7	22,4	22,9	Debe ser especificado por el comprador	3,0	23,6	9,7	66,5	15,9	4
3/4"	117,5	15,7	47,8	26,7	25,4	25,4	57,2	15,7	27,7	28,2		3,0	29,0	11,2	82,6	19,1	4
1"	124,0	17,5	54,0	33,5	26,9	26,9	62,0	17,5	34,5	35,1		3,0	35,8	12,7	88,9	19,1	4
1 1/4"	133,4	20,6	63,5	42,2	28,4	28,4	66,5	20,6	43,2	43,7		4,8	44,5	14,2	98,6	19,1	4
1 1/2"	155,6	22,4	69,9	48,3	31,8	31,8	69,9	22,4	49,5	50,0		6,4	50,5	15,7	114,3	22,4	4
2"	165,1	25,4	84,1	60,5	36,6	36,6	73,2	28,4	62,0	62,5		7,9	63,5	17,5	127,0	19,1	8
2 1/2"	190,5	28,4	100,1	73,2	41,1	41,1	79,2	31,8	74,7	75,4		7,9	76,2	19,1	149,4	22,4	8
3"	209,6	31,8	117,5	88,9	46,0	46,0	82,6	35,1	90,7	91,4		9,7	92,2	20,6	168,1	22,4	8
3 1/2"	228,6	35,1	133,4	101,6	49,3	49,3	85,9	39,6	103,4	104,1		9,7	104,9	-	184,2	25,4	8
4"	273,1	38,1	152,4	114,3	53,8	53,8	101,6	41,1	116,1	116,8		11,2	117,6	-	215,9	25,4	8
5"	330,2	44,5	189,0	141,2	60,5	60,5	114,3	47,8	143,8	144,5		11,2	144,5	-	266,7	28,6	8
6"	355,6	47,8	222,3	168,4	66,5	66,5	117,3	50,8	170,7	171,5		12,7	171,5	-	292,1	28,6	12
8"	419,1	55,6	273,1	219,2	76,2	76,2	133,4	57,2	221,5	222,3		12,7	222,3	-	349,3	31,8	12
10"	508,0	63,5	342,9	273,1	85,9	111,3	152,4	65,0	276,4	277,4		12,7	276,4	-	431,8	35,1	16
12"	558,8	66,5	400,1	323,9	91,9	117,3	155,4	69,9	327,2	328,2		12,7	328,7	-	489,0	35,1	20
14"	603,3	69,9	431,8	355,6	93,7	127,0	165,1	73,2	359,2	360,2		12,7	360,4	-	527,1	38,1	20
16"	685,8	76,2	495,3	406,4	106,4	139,7	177,8	77,7	410,5	411,2		12,7	411,2	-	603,3	41,3	20
18"	743,0	82,6	546,1	457,2	117,3	152,4	184,2	79,2	461,8	462,3		12,7	462,0	-	654,1	44,5	20
20"	812,8	88,9	609,6	508,0	127,0	165,1	190,5	82,6	513,1	514,4		12,7	512,8	-	723,9	44,5	24
24"	939,8	101,6	717,6	609,6	139,7	184,2	203,2	91,9	616,0	616,0		12,7	614,4	-	838,2	50,8	24

* Las dimensiones son milimétricas.

TAMBIÉN CONTAMOS CON BRIDAS CLASE 900. CONSULTE POR OTRAS CLASES Y/O NORMAS.

Accesorios - Serie Sanitaria

Accesorios para soldar a tope en diámetro real
AISI 304/304 L y AISI 316/316 L

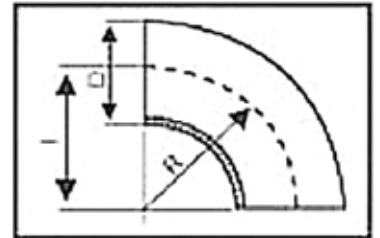
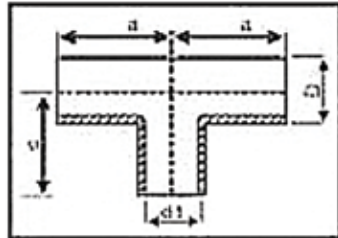

Te cuello largo

Ø Pulgadas	D mm	Espesor m	a mm
1"	25.4	1.50 - 2	46.1
1 1/4"	31.7	1.50 - 2	55.0
1 1/2"	38.1	1.50 - 2	60.3
2"	50.8	1.50 - 2	70.6
2 1/2"	63.5	1.50 - 2	80.7
3"	76.2	1.50 - 2	89.0
4"	101.6	2	114.3
5"	127.0	2	114.3
6"	152.4	2	133.0
8"	203.2	2-3	168.0
10"	254.0	2-3	248.0

Codo 90° Radio Largo radio =1.50 diámetro

Ø Pulgadas	D mm	Espesor m	a mm
1"	25.4	1.50 - 2	38.10
1 1/4"	31.7	1.50 - 2	47.55
1 1/2"	38.1	1.50 - 2	57.15
2"	50.8	1.50 - 2	76.20
2 1/2"	63.5	1.50 - 2	95.25
3"	76.2	1.50 - 2	114.30
4"	101.6	2	152.40
5"	127.0	2	190.50
6"	152.4	2	228.60
8"	203.2	2-3	304.80
10"	254.0	2-3	381.00

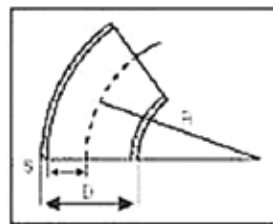

Codo 45° Radio Largo radio =1.50 diámetro

Ø Pulgadas	D mm	Espesor m	a mm
1"	25.4	1.50 - 2	38.10
1 1/4"	31.7	1.50 - 2	47.55
1 1/2"	38.1	1.50 - 2	57.15
2"	50.8	1.50 - 2	76.20
2 1/2"	63.5	1.50 - 2	95.25
3"	76.2	1.50 - 2	114.30
4"	101.6	2	152.40
5"	127.0	2	190.50
6"	152.4	2	228.60
8"	203.2	2-3	304.80
10"	254.0	2-3	381.00

Accesorios - Serie Sanitaria

Uniones Danesas
MATERIAL: AISI 304/316

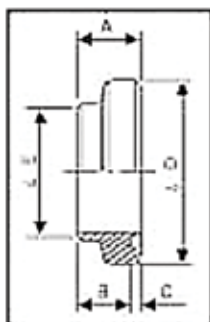

Manguito roscado - Norma Danesa

Ø	Dimensiones en mm				
Pulgadas	ext	a	b	c	d
1"	25.4	20.0	16.5	3.5	44
1 1/4"	31.7	20.0	16.5	3.5	52
1 1/2"	38.1	22.0	18.5	3.5	58
2"	50.8	24.0	20.5	3.5	72
2 1/2"	63.5	26.0	22.5	3.5	88
3"	76.2	28.0	24.5	3.5	100
4"	101.6	35.0	31.0	4.0	130
5"	127.0	36.5	32.5	4.0	160
6"	152.4	35.0	30.6	4.4	175

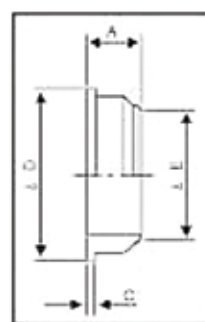

Manguito liso - Norma Danesa

Ø	Dimensiones en mm				
Pulgadas	ext	a	b	c	d
1"	25.4	16	16.5	3.0	39.5
1 1/4"	31.7	16	16.5	3.0	47.8
1 1/2"	38.1	18	18.5	3.0	53.5
2"	50.8	20	20.5	3.0	67.5
2 1/2"	63.5	22	22.5	4.0	83.5
3"	76.2	24	24.5	4.0	95.5
4"	101.6	30	31.0	5.0	123.0
5"	127.0	34	32.5	6.5	153.5
6"	152.4	25	30.6	6.0	168.0

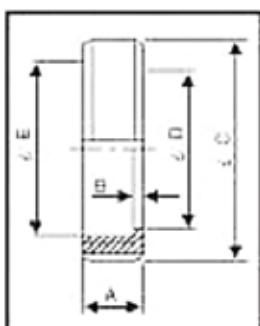

Tuerca - Norma Danesa

Ø	Dimensiones en mm				
Pulgadas	ext	a	b	c	d
1"	25.4	20	3	57	34.5
1 1/4"	31.7	20	3	65	42.0
1 1/2"	38.1	20	3	71	48.5
2"	50.8	22	3	86	62.0
2 1/2"	63.5	24	4	103	76.0
3"	76.2	25	4	115	88.0
4"	101.6	32	5	148	116.0
5"	127.0	35	5	178	140.0
6"	152.4	32	5	193	161.0

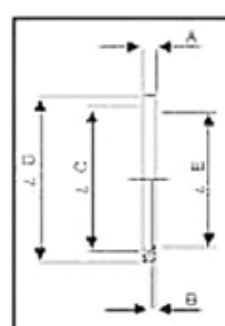

Junta - Norma Danesa

Ø	Dimensiones en mm				
Pulgadas	ext	a	b	c	d
1"	25.4	4.5	1	22.4	32.0
1 1/4"	31.7	4.5	1	28.7	41.0
1 1/2"	38.1	4.5	1	35.1	47.0
2"	50.8	4.5	1	47.8	59.0
2 1/2"	63.5	4.5	1	60.5	74.5
3"	76.2	4.5	1	73.2	88.0
4"	101.6	5.0	1	97.6	116.0
5"	127.0	5.0	1	123.0	139.0

Accesorios - Serie Sanitaria

Uniones Danesas
MATERIAL: AISI 304/316

Doble Danesa

Ø	Dimensiones en mm		
	ext	a	b
1"	25.4	36.5	57
1 1/4"	31.7	36.5	65
1 1/2"	38.1	40.5	71
2"	50.8	44.5	86
2 1/2"	63.5	48.5	103
3"	76.2	52.5	115
4"	101.6	65.5	148
5"	127.0	71.0	178
6"	152.4	60.5	193

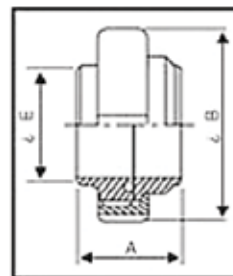

Clamp
MATERIAL: AISI 304/316.

Doble Clamp

Ø Pulgadas	Ext. mm	a mm
1"	25.4	44.5
1 1/4"	31.7	44.5
1 1/2"	38.1	44.5
2"	50.8	44.5
2 1/2"	63.5	57.5
3"	76.2	57.5
4"	101.6	57.5

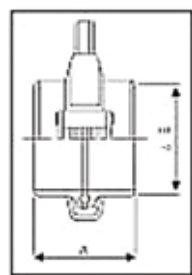

Manguito - Tipo Clamp

Ø Pulgadas	Dimensiones en mm			
	ext	a	b	c
1"	25.4	20	22.4	50.5
1 1/4"	31.7	20	28.7	50.5
1 1/2"	38.1	20	35.1	50.5
2"	50.8	20	47.8	64.0
2 1/2"	63.5	26	60.5	77.5
3"	76.2	26	73.2	91.0
4"	101.6	26	97.6	119.0

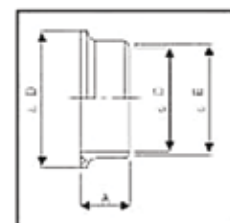

Abrazadera - Tipo Clamp
Duty Clamp

Abrazadera Clamp

Ø Pulgadas	Ext. mm	a mm
1"	25.4	88
1 1/4"	31.7	88
1 1/2"	38.1	88
2"	50.8	99
2 1/2"	63.5	114
3"	76.2	133
4"	101.6	158

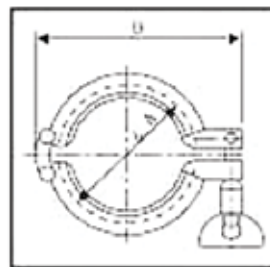

Accesorios - Serie Sanitaria

Reducciones Concéntricas
en AISI 304/304 L y AISI 316/316 L

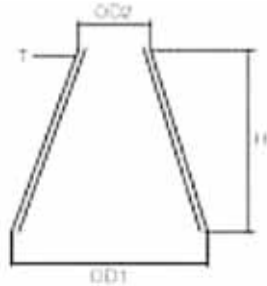

Reducciones Concéntricas

Ø exterior	D1	D2	T	H
1 1/4" x 1"	31.7	25.4	1.5 / 2	25.4
1 1/2" x 1"	38.1	25.4	1.5 / 2	50.8
1 1/2" x 1 1/4"	38.1	31.7	1.5 / 2	25.4
2" x 1"	50.8	25.4	1.5 / 2	102
2" x 1 1/4"	50.8	31.7	1.5 / 2	76.2
2" x 1 1/2"	50.8	38.1	1.5 / 2	50.8
2 1/2" x 1"	63.5	25.4	1.5 / 2	152.4
2 1/2" x 1 1/4"	63.5	31.7	1.5 / 2	127.0
2 1/2" x 1 1/2"	63.5	38.1	1.5 / 2	102.0
2 1/2" x 2"	63.5	50.8	1.5 / 2	50.8
3" x 1 1/4"	76.2	31.7	1.5 / 2	178.0
3" x 1 1/2"	76.2	38.1	1.5 / 2	152.4
3" x 2"	76.2	50.8	1.5 / 2	102.0
3" x 2 1/2"	76.2	63.5	1.5 / 2	50.8
4" x 1 1/2"	101.6	38.1	1.5 / 2	254.0
4" x 2"	101.6	50.8	1.5 / 2	203.0
4" x 2 1/2"	101.6	63.5	1.5 / 2	152.4
4" x 3"	101.6	76.2	2	102.0
5" x 2 1/2"	127.0	63.5	2 / 3	120.0
5" x 3"	127.0	76.2	.2 / 3	96.0
5" x 4"	127.0	101.6	.2 / 3	50.8
6" x 3"	152.4	76.2	.2 / 3	145.0
6" x 4"	152.4	101.6	.2 / 3	101.6
6" x 5"	152.4	127.0	.2 / 3	50.8
8" x 4"	203.2	101.6	.2 / 3	194.0
8" x 5"	203.2	127.0	.2 / 3	145.0
8" x 6"	203.2	152.4	.2 / 3	96.0
10" x 4"	254.0	101.6	.2 / 3	287.0
10" x 6"	254.0	152.4	.2 / 3	192.0
10" x 8"	254.0	203.2	.2 / 3	96.0

Accesorios - Serie Sanitaria

Válvulas Mariposas
MATERIAL: AISI 304/316

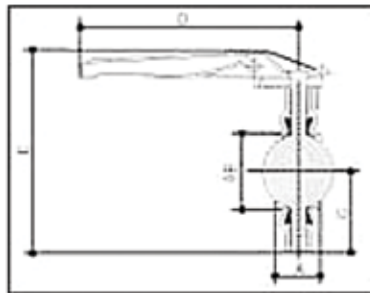

Válvulas Mariposa Estampada

Ø	Dimensiones en mm					
Pulgadas	ext Ø b	espesor	a	c	d	e
1"	25.4	2	25	40.5	140	122
1 1/4"	31.7	2	29.5	40.5	140	122
1 1/2"	38.1	3	31	48.5	178	150
2"	50.8	3	32	55	178	155
2 1/2"	63.5	3	42.5	66.5	203	173
3"	76.2	3	48	72	203	180
4"	101.6	3	50	88.5	203	215

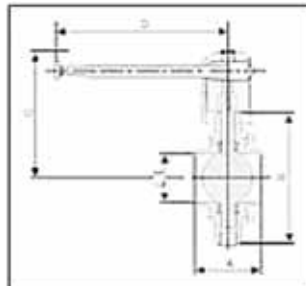

Válvulas Mariposa Mecanizada

Ø	Dimensiones en mm					
Pulgadas	ext	a	b	c	d	e
1"	25.4	40	87	89	102	22.4
1 1/4"	31.7	42	92	91	102	28.7
1 1/2"	38.1	50	97	94	132	35.1
2"	50.8	50	110	100	132	47.8
2 1/2"	63.5	50	127	109	132	60.5
3"	76.2	60	142	124	165	73.2
4"	101.6	64	162	135	165	97.6

Accesorios - Serie 150

Accesorios Roscados, Roscas ISO 7/1
Material: AISI 304/316

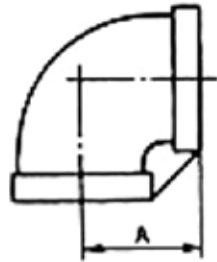

Codo 90°

Roscado Pulgadas	DN	A mm
1/4 "	8	20.6
3/8 "	10	24.1
1/2 "	15	28.5
3/4 "	20	33.3
1 "	25	38.1
1 1/4 "	32	44.5
1 1/2 "	40	49.3
2 "	50	57.2
3 "	80	78.23
4 "	100	96.27

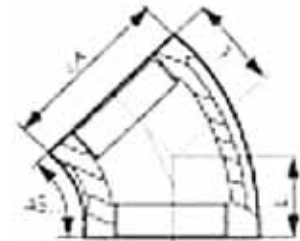

Codo 45°

Roscado Pulgadas	DN	A mm
1/4 "	8	18.54
3/8 "	10	20.32
1/2 "	15	22.35
3/4 "	20	24.89
1 "	25	28.49
1 1/4 "	32	32.77
1 1/2 "	40	36.32
2 "	50	42.67
3 "	80	55.12
4 "	100	66.29

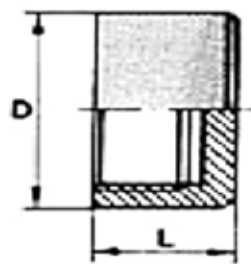

Tapa

Roscado Pulgadas	DN	L mm	D mm
1/8"	6	13	14.5
1/4"	8	17	18.0
3/8"	10	18	21.5
1/2"	15	22	27.0
3/4"	20	24	33.5
1"	25	28	40.4
1 1/4"	32	31	50.0
1 1/2"	40	31	57.0
2"	50	37	70.0
2 1/2"	65	42	86.0
3"	80	46	100.0
4"	100	52	138.6



Tapón Hexagonal

Roscado Pulgadas	DN	L mm	Longitud de roscado mm	Width across flats mm
1/8"	6	14	8.0	12.7
1/4"	8	17	11.0	14.3
3/8"	10	17	11.0	19.1
1/2"	15	21	15.0	22.0
3/4"	20	24	16.0	30.0
1"	25	27	18.0	36.0
1 1/4"	32	32	21.5	46.0
1 1/2"	40	33	21.5	50.0
2"	50	38	25.5	65.0
2 1/2"	65	45	30.5	80.0
3"	80	48	33.5	90.0
4"	100	52	35.6	120.6

Accesorios - Serie 150

Accesorios Roscados, Roscas ISO 7/1
Material: AISI 304/316

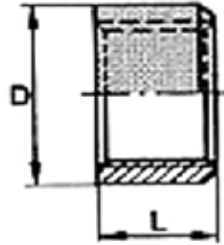

Media Cupla

Roscado Pulgadas	DN	L mm	D mm
1/8"	6	10.00	14.0
1/4"	8	11.00	18.5
3/8"	10	12.00	21.3
1/2"	15	15.00	36.5
3/4"	20	17.00	32.5
1"	25	19.50	39.5
1 1/4"	32	22.00	48.3
1 1/2"	40	22.00	55.5
2"	50	26.00	68.0
2 1/2"	65	30.50	82.0
3"	80	34.00	95.0
4"	100	41.29	122.6

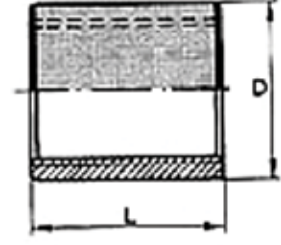

Cupla

Roscado Pulgadas	DN	L mm	D mm
1/8"	6	17	14.0
1/4"	8	25	18.5
3/8"	10	26	21.3
1/2"	15	34	26.5
3/4"	20	36	32.5
1"	25	43	39.5
1 1/4"	32	48	48.3
1 1/2"	40	48	55.5
2"	50	56	68.0
2 1/2"	65	65	82.0
3"	80	71	95.0
4"	100	83	122.60

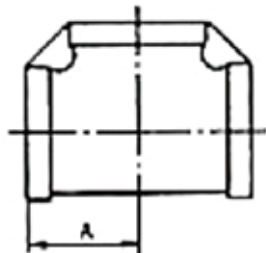

Te

Roscado Pulgadas	DN	A mm
1/4"	8	20.6 / 20.6
3/8"	10	24.1 / 24.1
1/2"	15	28.5 / 28.5
3/4"	20	33.3 / 33.3
1"	25	38.1 / 38.1
1 1/4"	32	44.5 / 44.5
1 1/2"	40	49.3 / 49.3
2"	50	57.2 / 57.2
3"	80	78.93 / 78.93
4"	100	96.27 / 96.27

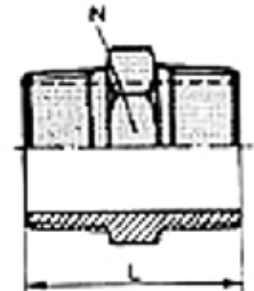

Niple Hexagonal

Roscado Pulgadas	DN	L mm	Width across flats	
			mm	N
1/8"	6	21.0	12.7	hex.
1/4"	8	28.0	14.3	
3/8"	10	29.0	19.1	
1/2"	15	36.0	22.0	
3/4"	20	41.0	30.0	
1"	25	46.5	36.0	
1 1/4"	32	54.0	46.0	
1 1/2"	40	54.0	50.0	
2"	50	65.5	65.0	hex.
2 1/2"	65	76.5	80.0	oct.
3"	80	85.0	90.0	
4"	100	95.0	120.0	

Accesorios - Serie 150

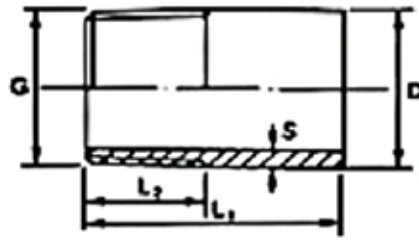

Medio Niple

G	L1 (Longitud Total)										D mm	S mm	L2 mm
	30	35	40	50	60	70	80	100	150	200			
1/8"	•							•	•	•	10.2	2.0	11
1/4"	•							•	•	•	13.5	2.3	12
3/8"	•							•	•	•	17.2	2.3	14
1/2"		•						•	•	•	21.3	2.6	16
3/4"			•					•	•	•	26.9	2.6	18
1"			•	•				•	•	•	33.7	3.2	21
1 1/4"				•	•			•	•	•	42.4	3.2	23
1 1/2"				•	•			•	•	•	48.3	3.2	23
2"				•	•			•	•	•	60.3	3.6	25
2 1/2"					•			•	•	•	76.1	3.6	30
3"						•		•	•	•	88.9	4.0	35
4"							•	•	•	•	114.3	4.5	45
• = Longitud Standard													

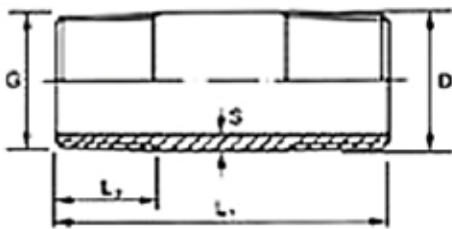

Niple

G	L1 (Longitud Total)							D mm	S mm	L2 mm
	40	65	80	100	120	150	200			
1/8"	•			•			•	10.2	2.0	11
1/4"	•			•			•	13.5	2.3	12
3/8"	•			•			•	17.2	2.3	14
1/2"		•		•			•	21.3	2.6	16
3/4"		•		•			•	26.9	2.6	18
1"		•		•			•	33.7	3.2	21
1 1/4"			•	•			•	42.4	3.2	23
1 1/2"			•	•			•	48.3	3.2	23
2"				•			•	60.3	3.6	25
2 1/2"				•			•	76.1	3.6	30
3"					•		•	88.9	4.0	35
4"					•	•	•	114.3	4.5	45
• = Longitud Standard										



Accesorios - Serie 150

Accesorios Roscados, Roscas ISO 7/1
Material: AISI 304/316



Buje de Reducción

Roscado Pulgadas	L mm	Width across flats mm N
1/4 x 1/8 "	17.0	14.3
3/8 x 1/8 "	17.5	19.1
3/8 x 1/4 "	17.5	19.1
1/2 x 1/8 "	21.0	22.0
1/2 x 1/4 "	21.0	22.0
1/2 x 3/8 "	21.0	22.0
3/4 x 3/8 "	24.5	30.0
3/4 x 1/2 "	24.5	30.0
1 x 1/4 "	27.0	36.0
1 x 3/8 "	27.0	36.0
1 x 1/2 "	27.0	36.0
1 x 3/4 "	27.0	36.0
1 1/4 x 1/2 "	32.5	46.0
1 1/4 x 3/4 "	32.5	46.0
1 1/4 x 1"	32.5	46.0
1 1/2 x 1/2 "	32.5	50.0
1 1/2 x 1"	32.5	50.0
1 1/2 x 1 1/4 "	32.5	50.0
2 x 1 1/4 "	40.0	65.0
2 x 1 1/2 "	40.0	65.0
2 1/2 x 2"	41.5	80.0
3 x 1 1/2 "	51.5	90.0
3 x 2"	51.5	90.0
3 x 2 1/2 "	51.5	90.0

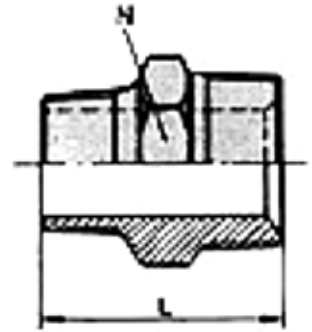

Unión Doble

Roscado Pulgadas	DN	L mm	Width across flats mm N
1/8 "	6	32	14.0
1/4 "	8	38	18.5
3/8 "	10	41	21.3
1/2 "	15	46	26.5
3/4 "	20	50	32.5
1"	25	56	39.5
1 1/4 "	32	62	48.3
1 1/2 "	40	64	55.5
2"	50	69	68.0
2 1/2 "	65	75	82.0
3"	80	83	95.0
4"	100	100	122.60

Accesorios - Serie 3000 lbs.

Accesorios Roscados NTP ASTM A182 3000lbs ANSI B16.11 / BS 3799
Material: AISI 304/304L or AISI 316/316L

Codo 90°

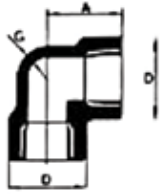

Nom. pipe size	A mm	D mm	G mm	Peso ~ kg/pce
1/4 "	20.6	25.4	3.30	0.14
3/8 "	24.6	33.3	3.51	0.27
1/2 "	28.6	38.1	4.09	0.40
3/4 "	33.3	46.0	4.27	0.63
1 "	38.1	55.6	4.98	1.10
1 1/4 "	44.5	61.9	5.28	1.22
1 1/2 "	50.8	75.4	5.54	2.35
2 "	60.3	84.1	6.05	3.30

Codo 45°



Nom. pipe size	A mm	D mm	G mm	Peso ~ kg/pce
1/4 "	19.1	25.4	3.30	0.14
3/8 "	22.2	33.3	3.51	0.25
1/2 "	25.4	38.1	4.09	0.32
3/4 "	28.4	46.0	4.27	0.51
1 "	33.3	55.6	4.98	0.85
1 1/4 "	34.9	61.9	5.28	1.00
1 1/2 "	42.9	75.4	5.54	1.85
2 "	43.7	84.1	6.05	3.00

Te

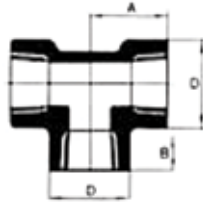

Nom. pipe size	A mm	D mm	B mm	Peso ~ kg/pce
1/4 "	24.6	25.4	8.13	0.19
3/8 "	28.6	33.3	9.14	0.39
1/2 "	33.3	38.1	10.92	0.52
3/4 "	38.1	46.0	12.27	0.83
1 "	44.5	55.6	14.73	1.38
1 1/4 "	50.8	61.9	17.02	1.66
1 1/2 "	60.3	75.4	17.78	3.12
2 "	63.5	84.1	19.05	4.00

Cupla

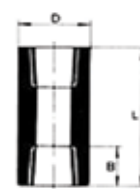

Nom. pipe size	L mm	D mm	B mm	Peso ~ kg/pce
1/4 "	34.9	19.1	8.13	0.05
3/8 "	38.1	22.2	9.14	0.06
1/2 "	47.6	28.6	10.92	0.14
3/4 "	50.8	34.9	12.70	0.20
1 "	60.3	44.5	14.73	0.40
1 1/4 "	66.7	57.6	17.02	0.70
1 1/2 "	79.4	63.5	17.78	1.00
2 "	85.7	76.2	19.05	1.90

Media Cupla

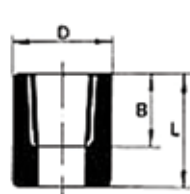

Nom. pipe size	L mm	D mm	B mm	Peso ~ kg/pce
1/4 "	17.4	19.1	8.13	0.03
3/8 "	19.1	22.2	9.14	0.05
1/2 "	23.8	28.6	10.92	0.07
3/4 "	25.4	34.9	12.70	0.10
1 "	30.2	44.5	14.73	0.20
1 1/4 "	33.3	57.2	17.02	0.32
1 1/2 "	39.7	36.5	17.78	0.50
2 "	42.9	76.2	19.05	0.95

Tapa

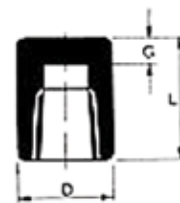

Nom. pipe size	L mm	D mm	G mm	Peso ~ kg/pce
1/4 "	25.4	19.1	4.76	0.05
3/8 "	25.4	22.2	4.76	0.06
1/2 "	31.8	28.6	6.35	0.12
3/4 "	36.5	34.9	6.35	0.19
1 "	41.3	44.5	9.53	0.35
1 1/4 "	44.5	57.2	9.53	0.56
1 1/2 "	44.5	63.5	11.11	0.75
2 "	47.6	76.2	12.70	1.45

Accesorios - Serie 3000 lbs.

Accesorios Roscados NTP
 ASTM A182 3000lbs ANSI B16.11 / BS 3799
 Material: AISI 304/304L or AISI 316/316L

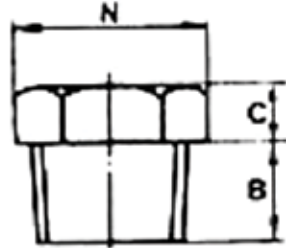

Tapón Hexagonal Macho

Nom. pipe size	B mm	N mm	C mm	Peso ~ kg/pce
1/4 "	15.0	16.0	6.0	0.03
3/8 "	16.0	18.0	8.0	0.05
1/2 "	20.0	22.0	8.0	0.08
3/4 "	21.0	27.0	10.0	0.15
1 "	25.0	35.0	10.0	0.25
1 1/4 "	26.0	45.0	14.0	0.50
1 1/2 "	26.0	51.0	16.0	0.65
2 "	27.0	64.0	18.0	1.10

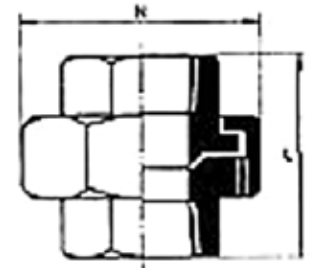

Unión

Nom. pipe size	L mm	N mm	Peso ~ kg/pce
1/4 "	42.1	32	0.13
3/8 "	47.6	36	0.20
1/2 "	50.0	43	0.40
3/4 "	57.9	50	0.50
1 "	63.5	60	1.00
1 1/4 "	71.4	70	1.45
1 1/2 "	77.8	78	1.60
2 "	87.3	95	2.50

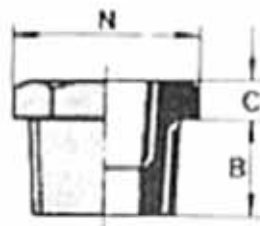

Buje de Reducción Hexagonal

Nom. pipe size	B mm	N mm	C mm	Peso ~ kg/pce
1/2 - 1/4 "	14	22	5	00.04
3/4 - 1/2 "	16	27	6	0.06
1 - 1/2 "	22	35	6	0.13
1 - 3/4 "	22	35	6	0.14
1 1/4 - 1 "	21	45	7	0.32
1 1/2 - 1 "	21	51	8	0.35
1 1/2 - 1 1/4 "	21	51	8	0.38
2 - 1 1/2 "	25	64	9	0.60

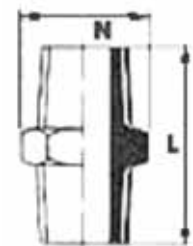

Niple Hexagonal

Nom. pipe size	L mm	N mm	Peso ~ kg/pce
1/4 "	36	16	0.03
3/8 "	41	17	0.06
1/2 "	49	22	0.09
3/4 "	55	27	0.12
1 "	63	36	0.17
1 1/4 "	65	46	0.29
1 1/2 "	65	50	0.34
2 "	67	63	0.55

Accesorios - Serie 3000 lbs.

Accesorios Socket Weld

ASTM A182 3000lbs ANSI B16.11 / BS 3799

Material: AISI 304/304L or AISI 316/316L

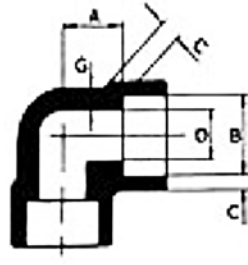

Codo 90°

Nom. pipe size	B mm	Depth of socket	C mm	G mm	D mm	A mm	Peso ~ kg/pce
1/4 "	14.10	9.53	3.30	3.02	8.86	11.11	0.09
3/8 "	17.53	9.53	3.51	3.20	12.14	13.49	0.13
1/2 "	21.72	9.53	4.09	3.73	15.42	15.88	0.25
3/4 "	27.05	12.70	4.27	3.91	20.55	19.05	0.32
1 "	33.78	12.70	4.98	4.55	26.26	22.23	0.52
1 1/4 "	42.55	12.70	5.28	4.85	34.67	26.99	0.86
1 1/2 "	48.64	12.70	5.54	5.08	40.51	31.75	1.12
2 "	61.11	15.88	6.05	5.54	52.12	38.10	1.80

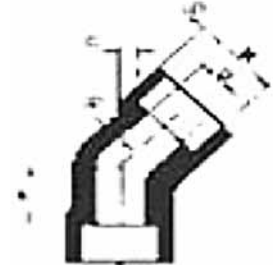

Codo 45°

Nom. pipe size	B mm	Depth of socket	C mm	G mm	D mm	A mm	Peso ~ kg/pce
1/4 "	14.10	9.53	3.30	3.02	8.86	7.94	0.08
3/8 "	17.53	9.53	3.51	3.20	12.14	7.94	0.13
1/2 "	21.72	9.53	4.09	3.73	15.42	11.11	0.18
3/4 "	27.05	12.70	4.27	3.91	20.55	12.70	0.30
1 "	33.78	12.70	4.98	4.55	26.26	14.29	0.45
1 1/4 "	42.55	12.70	5.28	4.85	34.67	17.46	0.75
1 1/2 "	48.64	12.70	5.54	5.08	40.51	20.64	0.90
2 "	61.11	15.88	6.05	5.54	52.12	25.40	1.30

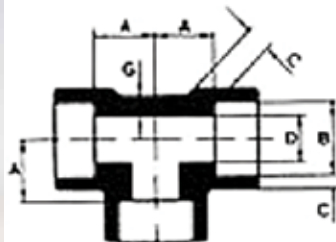

Te

Nom. pipe size	B mm	Depth of socket	C mm	G mm	D mm	A mm	Peso ~ kg/pce
1/4 "	14.10	9.53	3.30	3.02	8.86	11.11	0.11
3/8 "	17.53	9.53	3.51	3.20	12.14	13.49	0.16
1/2 "	21.72	9.53	4.09	3.73	15.42	15.88	0.34
3/4 "	27.05	12.70	4.27	3.91	20.55	19.05	0.41
1 "	33.78	12.70	4.98	4.55	26.26	22.23	0.65
1 1/4 "	42.55	12.70	5.28	4.85	34.67	26.99	0.95
1 1/2 "	48.64	12.70	5.54	5.08	40.51	31.75	1.33
2 "	61.11	15.88	6.05	5.54	52.12	38.10	2.20

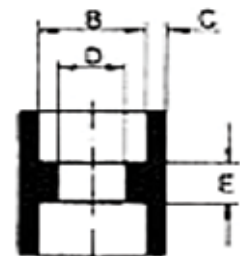

Cupla

Nom. pipe size	B mm	Depth of socket	C mm	G mm	D mm	E mm	Peso ~ kg/pce
1/4 "	14.10	9.53	3.30	3.02	8.86	6.35	0.05
3/8 "	17.53	9.53	3.51	3.20	12.14	6.35	0.10
1/2 "	21.72	9.53	4.09	3.73	15.42	9.53	0.14
3/4 "	27.05	12.70	4.27	3.91	20.55	9.53	0.20
1 "	33.78	12.70	4.98	4.55	26.26	12.70	0.30
1 1/4 "	42.55	12.70	5.28	4.85	34.67	12.70	0.45
1 1/2 "	48.64	12.70	5.54	5.08	40.51	12.70	0.60
2 "	61.11	15.88	6.05	5.54	52.12	19.05	0.95

Accesorios - Serie 3000 lbs.

Accesorios Socket Weld
 ASTM A182 3000lbs ANSI B16.11 / BS 3799
 Material: AISI 304/304L or AISI 316/316L

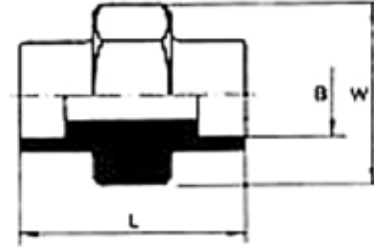

Unión

Nom. pipe size	B	Depth of socket	L	W	Peso ~ kg/pce
	mm		mm (min.)	mm (min.)	
1/4 "	14.10	9.53	37	32	0.20
3/8 "	17.53	9.53	37	36	0.35
1/2 "	21.72	9.53	38	41	0.40
3/4 "	27.05	12.70	46	50	0.45
1 "	33.78	12.70	52	60	1.00
1 1/4 "	42.55	12.70	54	70	1.30
1 1/2 "	48.64	12.70	56	78	1.70
2 "	61.11	15.88	68	95	3.00

Accesorios - Serie A-403

MATERIAL: AISI 304/304 L o AISI 316/316 L
 Accesorios para soldar a tope

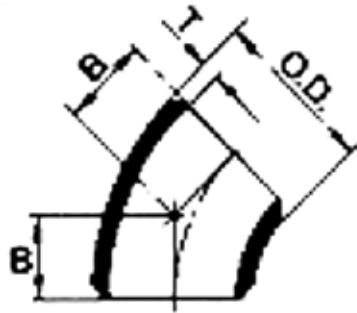

Codo 45° Radio Largo

Tamaño nominal	Schedule	Dimensiones en mm			Peso kg/pce
		OD	T	A	
1/2"	10s	21.3	2.11	15.9	0.030
	40s	21.3	2.77	15.9	0.035
3/4"	10s	26.7	2.11	11.1	0.030
	40s	26.7	2.87	11.1	0.040
1"	10s	33.4	2.77	22.2	0.090
	40s	33.4	3.38	22.2	0.110
1 1/4"	10s	42.4	2.77	25.4	0.110
	40s	42.4	3.56	25.4	0.170
1 1/2"	10s	48.3	2.77	28.6	0.170
	40s	48.3	3.68	28.6	0.230
2"	10s	60.3	2.77	34.9	0.250
	40s	60.3	3.91	34.9	0.400
2 1/2"	10s	73.0	3.05	44.5	0.480
	40s	73.0	5.16	44.5	0.770
3"	10s	88.9	3.05	50.8	0.630
	40s	88.9	5.49	50.8	1.080
4"	10s	114.3	3.05	63.5	1.080
	40s	114.3	6.02	63.5	2.090
5"	10s	141.3	3.40	79.4	1.810
	40s	141.3	6.55	79.4	3.430
6"	10s	168.3	3.40	95.3	2.720
	40s	168.3	7.11	95.3	5.440
8"	10s	219.1	3.76	127.0	5.330
	40s	219.1	8.18	127.0	10.770
10"	10s	273.1	4.19	159.0	9.750
	40s	273.1	9.27	159.0	19.280
12"	10s	323.9	4.57	190.5	13.610
	40s	323.9	9.53	190.5	29.710
14"	10s	355.6	4.78	222.3	18.140
16"	10s	406.4	4.78	254.0	23.810
18"	10s	457.2	4.78	285.8	29.940
20"	10s	508.0	5.54	317.5	49.890
24"	10s	609.6	6.35	381.0	70.310

Accesorios - Serie A-403

MATERIAL: AISI 304/304 L o AISI 316/316 L
Accesorios para soldar a tope

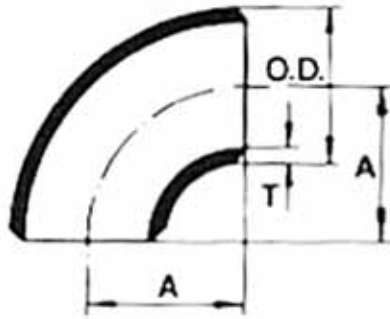

Codo 90° Radio Largo

Tamaño nominal	Schedule	Dimensiones en mm			Peso kg/pce
		OD	T	A	
1/2"	10s	21.3	2.11	38.1	0.060
	40s	21.3	2.77	38.1	0.080
	80s	21.3	3.73	38.1	0.100
3/4"	10s	26.7	2.11	38.1	0.070
	40s	26.7	2.87	38.1	0.090
	80s	26.7	3.91	38.1	0.110
1"	10s	33.4	2.77	38.1	0.140
	40s	33.4	3.38	38.1	0.160
	80s	33.4	4.55	38.1	0.220
1 1/4"	10s	42.2	2.77	47.6	0.230
	40s	42.2	3.56	47.6	0.250
	80s	42.2	4.85	47.6	0.400
1 1/2"	10s	48.3	2.77	57.2	0.310
	40s	48.3	3.68	57.2	0.400
	80s	48.3	5.08	57.2	0.510
2"	5s	60.3	1.65	76.2	0.290
	10s	60.3	2.77	76.2	0.510
	40s	60.3	3.91	76.2	0.710
	80s	60.3	5.54	76.2	0.910
2 1/2"	5s	73.0	2.11	95.3	0.680
	10s	73.0	3.05	95.3	0.850
	40s	73.0	5.16	95.3	1.360
	80s	73.0	7.01	95.3	1.810
3"	5s	88.9	2.11	114.3	0.910
	10s	88.9	3.05	114.3	1.220
	40s	88.9	5.49	114.3	2.180
	80s	88.9	7.62	114.3	2.980
3 1/2"	10s	101.6	3.05	133.4	1.700
	40s	101.6	5.74	133.4	1.830

Tamaño nominal	Schedule	Dimensiones en mm			Peso kg/pce
		OD	T	A	
4"	5s	114.3	2.11	152.4	1.500
	10s	114.3	3.05	152.4	2.150
	40s	114.3	6.02	152.4	4.170
5"	80s	114.3	8.56	152.4	6.180
	10s	141.3	3.40	190.5	3.630
	40s	141.3	6.55	190.5	6.860
6"	5s	168.3	2.77	228.6	4.540
	10s	168.3	3.40	228.6	5.440
	40s	168.3	7.11	228.6	10.890
8"	80s	168.3	10.97	228.6	16.330
	5s	219.1	2.77	304.8	7.850
	10s	219.1	3.76	304.8	10.660
10"	40s	219.1	8.18	304.8	21.550
	80s	219.1	12.70	304.8	33.110
	5s	273.1	3.40	381.0	14.510
12"	10s	273.1	4.19	381.0	19.500
	40s	273.1	9.27	381.0	38.560
	5s	323.9	3.96	457.2	23.130
14"	10s	323.9	4.57	457.2	27.220
	40s	323.9	9.53	457.2	59.420
	10s	355.6	4.78	533.4	36.300
16"	STD	355.6	9.53	533.4	70.300
	10s	406.4	4.78	609.6	47.630
18"	STD	406.4	9.53	609.6	91.630
	10s	457.2	4.78	685.8	59.870
20"	10s	508.0	5.54	762.0	99.790
24"	10s	609.6	6.35	914.4	140.610

Accesorios - Serie A-403

MATERIAL: AISI 304/304 L o AISI 316/316 L
 Accesorios para soldar a tope

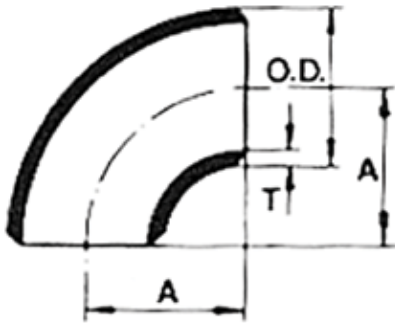

Codo 90° Radio Corto

Tamaño nominal	Schedule	Dimensiones en mm			Peso kg/pce
		OD	T	A	
1"	10s	33.4	2.77	25.4	0.100
	40s	33.4	3.38	25.4	0.120
1 1/4"	40s	42.4	3.56	31.8	0.200
1 1/2"	10s	48.3	2.77	38.1	0.220
	40s	48.3	3.68	38.1	0.290
2"	10s	60.3	2.77	50.8	0.370
	40s	60.3	3.91	50.8	0.510
2 1/2"	10s	73.0	3.05	63.5	0.620
	40s	73.0	5.16	63.5	1.020
3"	10s	88.9	3.05	76.2	0.980
	40s	88.9	5.49	76.2	1.500
4"	10s	114.3	3.05	101.6	1.720
	40s	114.3	6.02	101.6	3.120
6"	10s	168.3	3.40	152.4	4.150
	40s	168.3	7.11	152.4	7.150
8"	10s	219.1	3.76	203.2	8.000
	40s	219.1	8.18	203.2	17.050
10"	10s	273.1	4.19	254.0	12.400
12"	10s	323.9	4.57	304.8	17.200
14"	10s	355.6	4.78	355.6	23.590
16"	10s	466.4	4.78	406.4	30.840

Accesorios - Serie A-403

MATERIAL: AISI 304/304 L o AISI 316/316 L
Accesorios para soldar a tope



Reducciones Concéntricas

Tamaño nominal Run x Outlet	Schedule	Dimensiones en mm					Peso kg/pce
		O.D. 1	O.D. 2	T	t	H	
3/4 x 1/2"	10s	26.7	21.3	2.11	2.11	39.3	0.100
	40s	26.7	21.3	2.87	2.77	39.3	0.140
	80s	26.7	21.3	3.91	3.73	39.3	0.180
1 x 1/2"	10s	33.4	21.3	2.77	2.11	50.8	0.120
	40s	33.4	21.3	3.38	2.77	50.8	0.150
	80s	33.4	21.3	4.55	3.73	50.8	0.200
1 x 3/4"	10s	33.4	26.7	2.77	2.11	50.8	0.130
	40s	33.4	26.7	3.38	2.87	50.8	0.160
	80s	33.4	26.7	4.55	3.91	50.8	0.220
1 1/4 x 3/4"	10s	42.2	26.7	2.77	2.11	50.8	0.180
	40s	42.2	26.7	3.56	2.87	50.8	0.220
1 1/4 x 1"	10s	42.2	33.4	2.77	2.77	50.8	0.180
	40s	42.2	33.4	3.56	3.38	50.8	0.220
	80s	42.2	33.4	4.85	4.55	50.8	0.270
1 1/2 x 1/2"	10s	48.3	21.3	2.77	2.11	63.5	0.200
	40s	48.3	21.3	3.68	2.77	63.5	0.250
1 1/2 x 3/4"	10s	48.3	26.7	2.77	2.11	63.5	0.200
	40s	48.3	26.7	3.68	2.87	63.5	0.260
	80s	48.3	26.7	5.08	3.91	63.5	0.370
1 1/2 x 1"	10s	48.3	33.4	2.77	2.77	63.5	0.200
	40s	48.3	33.4	3.68	3.38	63.5	0.260
	80s	48.3	33.4	5.08	4.55	63.5	0.340
1 1/2 x 1 1/4"	10s	48.3	42.2	2.77	2.77	63.5	0.210
	40s	48.3	42.2	3.68	3.56	63.5	0.280
2 x 3/4"	10s	60.3	26.7	2.77	2.11	76.2	0.250
	40s	60.3	26.7	3.91	2.87	76.2	0.370
2 x 1"	10s	60.3	33.4	2.77	2.77	76.2	0.280
	40s	60.3	33.4	3.91	3.38	76.2	0.400
	80s	60.3	33.4	5.54	4.55	76.2	0.540
2 x 1 1/4"	10s	60.3	42.2	2.77	2.77	76.2	0.300
	40s	60.3	42.2	3.91	3.56	76.2	0.440
2 x 1 1/2"	10s	60.3	48.3	2.77	2.77	76.2	0.310
	40s	60.3	48.3	3.91	3.68	76.2	0.450
	80s	60.3	48.3	5.54	5.08	76.2	0.590
2 1/2 x 1 1/2"	10s	73.0	48.3	3.05	2.77	88.9	0.440
	40s	73.0	48.3	5.16	3.68	88.9	0.769
2 1/2 x 2"	10s	73.0	60.3	3.05	2.77	88.9	0.470
	40s	73.0	60.3	5.16	3.91	88.9	0.800
	80s	73.0	60.3	7.01	5.54	88.9	1.030
3 x 1"	10s	88.9	33.4	3.05	2.77	88.9	0.490
	40s	88.9	33.4	5.49	3.38	88.9	0.850
3 x 1 1/2"	10s	88.9	48.3	3.05	2.77	88.9	0.510
	40s	88.9	48.3	5.49	3.68	88.9	0.940
	80s	88.9	48.3	7.62	5.08	88.9	1.210
3 x 2"	10s	88.9	60.3	3.05	2.77	88.9	0.550
	40s	88.9	60.3	5.49	3.91	88.9	1.000
	80s	88.9	60.3	7.62	5.54	88.9	1.290

Tamaño nominal Run x Outlet	Schedule	Dimensiones en mm					Peso kg/pce
		O.D. 1	O.D. 2	T	t	H	
3 x 2 1/2"	10s	88.9	73.0	3.05	3.05	88.9	0.590
	40s	88.9	73.0	5.49	5.16	88.9	1.080
	80s	88.9	73.0	7.62	7.01	88.9	1.490
4 x 1 1/2"	10s	114.3	48.3	3.05	2.77	101.6	0.710
	4 x 2"	10s	114.3	60.3	3.05	2.77	101.6
40s		114.3	60.3	6.02	3.91	101.6	1.570
80s		114.3	60.3	8.56	5.54	101.6	1.950
4 x 2 1/2"	10s	114.3	73.0	3.05	3.05	101.6	0.830
	40s	114.3	73.0	6.02	5.16	101.6	1.660
4 x 3"	10s	114.3	88.9	3.05	3.05	101.6	0.870
	40s	114.3	88.9	6.02	5.49	101.6	1.740
	80s	114.3	88.9	8.56	7.62	101.6	2.330
5 x 3"	10s	141.3	88.9	3.40	3.05	127.0	1.450
	40s	141.3	88.9	6.55	5.49	127.0	2.850
5 x 4"	10s	141.3	114.3	3.40	3.05	127.0	1.490
	40s	141.3	114.3	6.55	6.02	127.0	2.980
6 x 3"	10s	168.3	88.9	3.40	3.05	139.7	1.820
	40s	168.3	88.9	7.11	5.49	139.7	3.980
	80s	168.3	88.9	10.97	7.62	139.7	5.510
6 x 4"	10s	168.3	114.3	3.40	3.05	139.7	1.950
	40s	168.3	114.3	7.11	6.02	139.7	4.080
	80s	168.3	114.3	10.97	8.56	139.7	5.960
6 x 5"	10s	168.3	141.4	3.40	3.40	139.7	2.050
	40s	168.3	141.4	7.11	6.55	139.7	4.180
8 x 4"	10s	219.1	114.3	3.76	3.05	152.4	3.020
	40s	219.1	114.3	8.18	6.02	152.4	6.550
8 x 5"	10s	219.1	141.3	3.76	3.40	152.4	3.080
	40s	219.1	141.3	8.18	6.55	152.4	6.700
8 x 6"	10s	219.1	168.3	3.76	3.40	152.4	3.190
	40s	219.1	168.3	8.18	7.11	152.4	6.940
10 x 6"	10s	273.1	168.3	4.19	3.40	177.8	5.000
	40s	273.1	168.3	9.27	7.11	177.8	11.120
10 x 8"	10s	273.1	219.1	4.19	3.76	177.8	5.250
	40s	273.1	219.1	9.27	8.18	177.8	11.560
12 x 6"	10s	323.9	168.3	4.57	3.40	203.2	6.580
	40s	323.9	168.3	9.53	7.11	203.2	12.800
12 x 8"	10s	323.9	219.1	4.57	3.76	203.2	7.670
	40s	323.9	219.1	9.53	8.18	203.2	15.980
	80s	323.9	219.1	13.51	11.18	203.2	23.300
12 x 10"	10s	323.9	273.1	4.57	4.19	203.2	7.980
	40s	323.9	273.1	9.53	9.27	203.2	16.630
14 x 8"	10s	355.6	219.1	4.78	3.76	330.2	13.880
14 x 10"	10s	355.6	273.1	4.78	4.19	330.2	14.410
14 x 12"	10s	355.6	323.9	4.78	4.57	330.2	15.290
16 x 8"	10s	406.4	219.1	4.78	3.76	330.2	16.500
16 x 10"	10s	406.4	273.1	4.78	4.19	355.6	17.720
16 x 12"	10s	406.4	323.9	4.78	4.57	355.6	18.350
16 x 14"	10s	406.4	355.6	4.78	4.78	355.6	18.900

Accesorios - Serie A-403

MATERIAL: AISI 304/304 L o AISI 316/316 L
Accesorios para soldar a tope

Tapa

Tamaño nominal Run x Outlet	Schedule	Dimensiones en mm			Peso kg/pce
		OD	T	E	
1/2"	10s	21.3	2.11	25.4	0.040
	40s	21.3	2.77	25.4	0.050
3/4"	10s	26.7	2.11	25.4	0.050
	40s	26.7	2.87	25.4	0.060
1"	10s	33.4	2.77	38.1	0.090
	40s	33.4	3.38	38.1	0.130
1 1/4"	10s	42.2	2.77	38.1	0.130
	40s	42.2	3.56	38.1	0.170
1 1/2"	10s	48.3	2.77	38.1	0.140
	40s	48.3	3.68	38.1	0.230
2"	10s	60.3	2.77	38.1	0.170
	40s	60.3	3.91	38.1	0.270
2 1/2"	10s	73.0	3.05	38.1	0.250
	40s	73.0	5.16	38.1	0.450
3"	10s	88.9	3.05	50.8	0.400
	40s	88.9	5.49	50.8	0.710
4"	10s	114.3	3.05	63.5	0.650
	40s	114.3	6.02	63.5	1.220
5"	10s	141.3	3.40	76.2	1.020
6"	10s	168.3	3.40	88.9	1.360
	40s	168.3	7.11	88.9	3.230
8"	10s	219.1	3.76	101.6	2.490
	40s	219.1	8.18	101.6	5.670
10"	10s	273.1	4.19	127.0	4.900
	40s	273.1	9.27	127.0	9.210
12"	10s	323.9	4.57	152.4	6.530
	40s	323.9	9.53	152.4	13.060
14"	10s	355.6	4.78	165.1	8.160
16"	10s	406.4	4.78	177.8	14.510
18"	10s	457.2	4.78	203.2	17.960
20"	10s	508.0	5.54	228.6	27.220
24"	10s	609.6	6.35	266.7	34.470

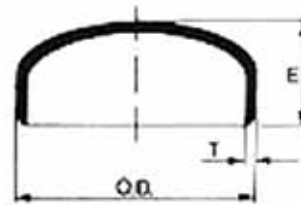

Accesorios - Serie A-403

MATERIAL: AISI 304/304 L o AISI 316/316 L
Accesorios para soldar a tope



Reducciones Excéntricas

Tamaño nominal Run x Outlet	Sche- dule	Dimensiones en mm					Peso kg/pce	Tamaño nominal Run x Outlet	Sche- dule	Dimensiones en mm					Peso kg/pce
		O.D. 1	O.D. 2	T	t	H				O.D. 1	O.D. 2	T	t	H	
3/4 x 1/2"	10s	26.7	21.3	2.11	2.11	39.3	0.100	5 x 3"	10s	141.3	88.9	3.40	3.05	127.0	1.450
	40s	26.7	21.3	2.87	2.77	39.3	0.140		40s	141.3	88.9	6.55	5.49	127.0	2.850
1 x 1/2"	10s	33.4	21.3	2.77	2.11	50.8	0.120	5 x 4"	10s	141.3	114.3	3.40	3.05	127.0	1.490
	40s	33.4	21.3	3.38	2.77	50.8	0.150		40s	141.3	114.3	6.55	6.02	127.0	2.980
1 x 3/4"	10s	33.4	26.7	2.77	2.11	50.8	0.130	6 x 3"	10s	168.3	88.9	3.40	3.05	139.7	1.820
	40s	33.4	26.7	3.38	2.87	50.8	0.160		40s	168.3	88.9	7.11	5.49	139.7	3.980
1 1/4 x 1"	10s	42.2	33.4	2.77	2.77	50.8	0.180	6 x 4"	10s	168.3	114.3	3.40	3.05	139.7	1.950
	40s	42.2	33.4	3.56	3.38	50.8	0.220		40s	168.3	114.3	7.11	6.02	139.7	4.080
1 1/2 x 3/4"	10s	48.3	26.7	2.77	2.11	63.5	0.200	6 x 5"	10s	168.3	141.3	3.40	3.40	139.7	2.000
	40s	48.3	26.7	3.68	2.87	63.5	0.260		40s	168.3	141.3	7.11	6.55	139.7	4.150
1 1/2 x 1"	10s	48.3	33.4	2.77	2.77	63.5	0.200	8 x 4"	10s	219.1	114.4	3.76	3.05	152.4	3.020
	40s	48.3	33.4	3.68	3.38	63.5	0.260		40s	219.1	114.4	8.18	6.02	152.4	6.550
1 1/2 x 1 1/4"	10s	48.3	42.2	2.77	2.77	63.5	0.210	8 x 5"	10s	219.1	141.3	3.76	3.05	152.4	3.080
	40s	48.3	42.2	3.68	3.56	63.5	0.280		40s	219.1	141.3	8.18	6.02	152.4	6.700
2 x 1"	10s	60.3	33.4	2.77	2.77	76.2	0.280	8 x 6"	10s	219.1	168.3	3.76	3.40	152.4	3.190
	40s	60.3	33.4	3.91	3.38	76.2	0.400		40s	219.1	168.3	8.18	7.11	152.4	6.940
2 x 1 1/4"	10s	60.3	42.2	2.77	2.77	76.2	0.300	10 x 6"	10s	273.1	168.3	4.19	3.40	177.8	5.000
	40s	60.3	42.2	3.68	3.56	76.2	0.450		40s	273.1	168.3	9.27	7.11	177.8	11.120
2 x 1 1/2"	10s	60.3	48.3	2.77	2.77	76.2	0.310	10 x 8"	10s	273.1	219.1	4.19	3.76	177.8	5.250
	40s	60.3	48.3	3.91	3.68	76.2	0.450		40s	273.1	219.1	9.27	8.18	177.8	11.560
2 1/2 x 2"	10s	73.0	60.3	3.05	2.77	88.9	0.470	12 x 6"	10s	323.9	168.3	4.57	3.40	203.2	7.450
	40s	73.0	60.3	5.16	3.91	88.9	0.800		40s	323.9	168.3	9.53	7.11	203.2	11.120
3 x 1 1/2"	10s	88.9	48.3	3.05	2.77	88.9	0.510	12 x 8"	10s	323.9	219.1	4.57	3.76	203.2	7.670
	40s	88.9	48.3	5.49	3.68	88.9	0.940		40s	323.9	219.1	9.53	8.18	203.2	15.980
3 x 2"	10s	88.9	60.3	3.05	2.77	88.9	0.550	12 x 10"	10s	323.9	273.1	4.57	4.19	203.2	7.980
	40s	88.9	60.3	5.49	3.91	88.9	1.000		40s	323.9	273.1	9.53	9.27	203.2	16.630
3 x 2 1/2"	10s	88.9	73.0	3.05	2.77	88.9	0.590	14 x 10"	10s	355.6	273.1	4.78	4.19	330.2	14.410
	40s	88.9	73.0	5.49	5.16	88.9	1.080		10s	355.6	323.9	4.78	4.19	330.2	15.290
4 x 2"	10s	114.3	60.3	3.05	2.77	101.6	0.780	16 x 10"	10s	406.4	273.1	4.78	4.19	355.6	17.720
	40s	114.3	60.3	6.02	3.91	101.6	1.570		10s	406.4	323.9	4.78	4.19	355.6	18.350
4 x 2 1/2"	10s	114.3	73.0	3.05	3.05	101.6	0.830								
	40s	114.3	73.0	6.02	5.16	101.6	1.660								
4 x 3"	10s	114.3	88.9	3.05	3.05	101.6	0.870								
	40s	114.3	88.9	6.02	5.49	101.6	1.740								

Accesorios - Serie A-403

Te

Tamaño nominal	Schedule	Dimensiones en mm			Peso kg/pce
		OD	1	C/M	
1/2"	10s	21.3	2.11	25.4	0.065
	40s	21.3	2.77	25.4	0.085
3/4"	80s	21.3	3.73	25.4	0.140
	10s	26.7	2.11	28.6	0.092
	40s	26.7	2.87	28.6	0.115
	80s	26.7	3.91	28.6	0.200
1"	10s	33.4	2.77	38.1	0.200
	40s	33.4	3.38	38.1	0.245
1 1/4"	80s	33.4	4.55	38.1	0.390
	10s	42.2	2.77	47.6	0.330
1 1/2"	40s	42.2	3.56	47.6	0.420
	10s	48.3	2.77	57.2	0.460
	40s	48.3	3.68	57.2	0.595
	80s	48.3	5.08	57.2	1.020
2"	10s	60.3	2.77	63.5	0.630
	40s	60.3	3.91	63.5	0.872
	80s	60.3	5.54	63.5	1.590
	10s	73.0	3.05	76.2	1.100
3"	40s	73.0	5.16	76.2	1.700
	10s	88.9	3.05	85.7	1.370
	40s	88.9	5.49	85.7	1.900
	80s	88.9	7.62	85.7	4.450
3 1/2"	10s	101.6	3.05	95.3	1.740
	40s	101.6	5.74	95.3	3.190
4"	10s	114.3	3.05	104.8	2.150
	40s	114.3	6.02	104.8	4.130
	80s	114.3	8.56	104.8	7.710
	10s	141.3	3.40	123.8	3.480
6"	40s	141.3	6.55	123.8	6.550
	10s	168.3	3.40	142.9	4.760
	40s	168.3	7.11	142.9	9.730
	80s	168.3	10.97	142.9	13.610
8"	10s	219.1	3.76	177.8	8.460
	40s	219.1	8.18	177.8	18.000
10"	10s	273.1	4.19	215.9	14.200
	40s	273.1	9.27	215.9	30.800
12"	10s	323.9	4.57	254.0	21.600
	40s	323.9	9.53	254.0	44.300
14"	10s	355.6	4.78	279.4	48.530
	STD	355.6	9.53	279.4	79.380
16"	10s	406.4	4.78	304.8	58.970
	STD	406.4	9.53	304.8	99.790
18"	10s	457.2	4.78	342.9	76.660
20"	10s	508.0	5.54	381.0	103.420
24"	10s	609.6	6.35	431.8	155.580

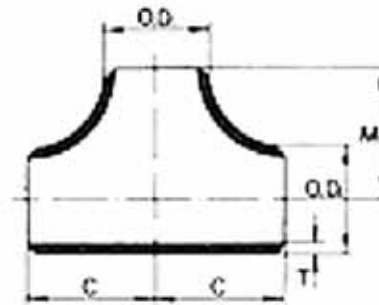

Accesorios - Serie A-403

MATERIAL: AISI 304/304 L o AISI 316/316 L
Accesorios para soldar a tope

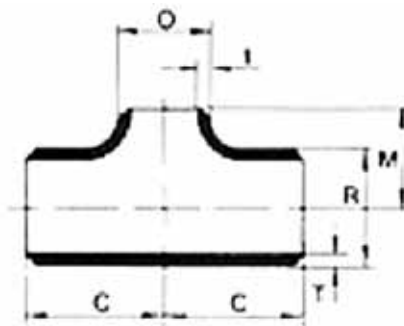

Te de Reducción

Tamaño nominal Run x Outlet	Sche- dule	Dimensiones en mm						Peso kg/pce	Tamaño nominal Run x Outlet	Sche- dule	Dimensiones en mm						Peso kg/pce
		R	O	T	t	C	M				R	O	T	t	C	M	
3/4 x 1/2"	10s	26.7	21.3	2.11	2.11	29	29	0.110	4 x 2 1/2"	10s	114.3	73.0	3.05	3.05	105	95	2.450
	40s	26.7	21.3	2.87	2.77	29	29	0.150		40s	114.3	73.0	6.02	5.16	105	95	4.700
1 x 1/2"	10s	33.4	21.3	2.77	2.11	38	38	0.190	4 x 3"	10s	114.3	88.9	3.05	3.05	105	98	2.500
	40s	33.4	21.3	3.38	2.77	38	38	0.220		40s	114.3	88.9	6.02	5.49	105	98	4.800
1 x 3/4"	10s	33.4	26.7	2.77	2.11	38	38	0.190	5 x 3"	10s	114.3	88.9	3.40	3.05	124	111	3.130
	40s	33.4	26.7	3.38	2.87	38	38	0.230		40s	114.3	88.9	6.55	5.49	124	111	5.850
1 1/4 x 1"	10s	42.2	33.4	2.77	2.77	47.6	47.6	0.450	5 x 4"	10s	141.3	114.3	3.40	3.05	124	117	3.260
	40s	42.2	33.4	3.68	3.38	47.6	47.6	0.530		40s	141.3	114.3	6.55	6.02	124	117	6.140
1 1/2 x 1/2"	10s	48.3	21.3	2.77	2.11	57	57	0.390	6 x 3"	10s	141.3	88.9	3.40	3.05	143	124	4.900
	40s	48.3	21.3	3.68	2.77	57	57	0.520		40s	141.3	88.9	7.11	5.49	143	124	9.800
1 1/2 x 3/4"	10s	48.3	26.7	2.77	2.11	57	57	0.390	6 x 4"	10s	168.3	114.3	3.40	3.05	143	130	5.100
	40s	48.3	26.7	3.68	2.87	57	57	0.520		40s	168.3	114.3	7.11	6.02	143	130	10.000
1 1/2 x 1"	10s	48.3	33.4	2.77	2.77	57	57	0.420	6 x 5"	10s	168.3	141.3	3.40	3.40	143	137	5.300
	40s	48.3	33.4	3.68	3.38	57	57	0.550		40s	168.3	141.3	7.11	6.55	143	137	10.400
2 x 3/4"	10s	60.3	26.7	2.77	2.11	64	44	0.510	8 x 4"	10s	168.3	114.3	3.76	3.05	178	156	8.000
	40s	60.3	26.7	3.91	2.87	64	44	0.710		40s	168.3	114.3	8.18	6.02	178	156	17.500
2 x 1"	10s	60.3	33.4	2.77	2.77	64	51	0.540	8 x 6"	10s	219.1	168.3	3.76	3.40	178	168	8.400
	40s	60.3	33.4	3.91	3.38	64	51	0.740		40s	219.1	168.3	8.18	7.11	178	168	18.100
2 x 1 1/2"	10s	60.3	48.3	2.77	2.77	64	60	0.590	10 x 4"	10s	219.1	114.3	4.19	3.05	216	184	13.500
	40s	60.3	48.3	3.91	3.68	64	60	0.830		40s	219.1	114.3	9.27	6.02	216	184	29.300
2 1/2 x 1 1/2"	10s	73.0	48.3	3.05	2.77	76	67	0.900	10 x 6"	10s	273.1	168.3	4.19	3.40	216	194	14.000
	40s	73.0	48.3	5.16	3.68	76	67	1.490		40s	273.1	168.3	9.27	7.11	216	194	30.000
2 1/2 x 2"	10s	73.0	60.3	3.05	2.77	76	70	0.940	10 x 8"	10s	273.1	219.1	4.19	3.76	216	203	14.500
	40s	73.0	60.3	5.16	3.91	76	70	1.530		40s	273.1	219.1	9.27	8.18	216	203	31.000
3 x 1 1/2"	10s	88.9	48.3	3.05	2.77	86	73	1.190	12 x 6"	10s	273.1	168.5	4.57	3.40	254	219	23.000
	40s	88.9	48.3	5.49	3.68	86	73	2.050		40s	273.1	168.5	9.53	7.11	254	219	52.000
3 x 2"	10s	88.9	60.3	3.05	2.77	86	76	1.230	12 x 8"	10s	323.9	219.1	4.57	3.76	254	229	24.000
	40s	88.9	60.3	5.49	3.91	86	76	2.160		40s	323.9	219.1	9.53	8.18	254	229	53.000
3 x 2 1/2"	10s	88.9	73.0	3.05	3.05	86	83	1.310	12 x 10"	10s	323.9	273.1	4.57	3.76	254	241	25.000
	40s	88.9	73.0	5.49	5.16	86	83	2.290		40s	323.9	273.1	9.53	9.27	254	241	54.000
4 x 2"	10s		60.3	3.05	3.05	105	89	2.350									
	40s		60.3	6.02	3.91	105	89	4.500									

Accesorios - Serie A-403

MATERIAL: AISI 304/304 L o AISI 316/316 L
Accesorios para soldar a tope

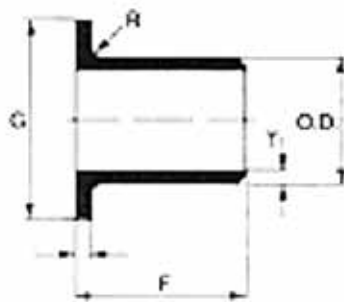

Stub Ends - Pestana

Tamaño nominal Run x Outlet	Schedule	Dimensiones en mm					Peso kg/pce
		OD 1	T	G	F	R máx.	
1/2"	10s	21.3	2.11	34.9	50.8	3.18	0.070
	40s	21.3	2.77	34.9	50.8	3.18	0.090
3/4"	10s	26.7	2.11	42.9	50.8	3.18	0.100
	40s	26.7	2.87	42.9	50.8	3.18	0.120
1"	10s	33.4	2.77	50.8	50.8	3.18	0.160
	40s	33.4	3.38	50.8	50.8	3.18	0.170
1 1/4"	10s	42.2	2.77	63.5	50.8	4.76	0.220
	40s	42.2	3.56	63.5	50.8	4.76	0.250
1 1/2"	10s	48.3	2.77	73.0	50.8	6.35	0.250
	40s	48.3	3.68	73.0	50.8	6.35	0.310
2"	10s	60.3	2.77	92.1	63.5	7.94	0.430
	40s	60.3	3.91	92.1	63.5	7.94	0.610
2 1/2"	10s	73.0	3.05	104.8	63.5	7.94	0.570
	40s	73.0	5.16	104.8	63.5	7.94	0.800
3"	10s	88.9	3.05	127.0	63.5	9.53	0.730
	40s	88.9	5.49	127.0	63.5	9.53	1.130
4"	10s	114.3	3.05	157.2	76.2	11.11	1.090
	40s	114.3	6.02	157.2	76.2	11.11	1.870
5"	10s	141.3	3.40	185.7	76.2	11.11	1.470
	40s	141.3	6.55	185.7	76.2	11.11	2.280
6"	10s	168.3	3.40	215.9	88.9	12.70	2.150
	40s	168.3	7.11	215.9	88.9	12.70	3.570
8"	10s	219.1	3.76	269.9	101.6	12.70	3.220
	40s	219.1	8.18	269.9	101.6	12.70	6.070
10"	10s	273.1	4.19	323.9	127.0	12.70	5.130
	40s	273.1	9.27	323.9	127.0	12.70	10.070
12"	10s	323.9	4.57	381.0	152.4	12.70	8.160
	40s	323.9	9.53	381.0	152.4	12.70	14.290
14"	10s	355.6	4.78	412.8	152.4	12.70	10.890
16"	10s	406.4	4.78	469.9	152.4	12.70	12.700
18"	10s	457.2	4.78	533.4	152.4	12.70	17.240
20"	10s	508.0	5.54	584.2	152.4	12.70	21.770
24"	10s	609.6	6.35	692.2	152.4	12.70	27.220

Accesorios - Serie A-403

MATERIAL: AISI 304/304 L o AISI 316/316 L
 Accesorios para soldar a tope

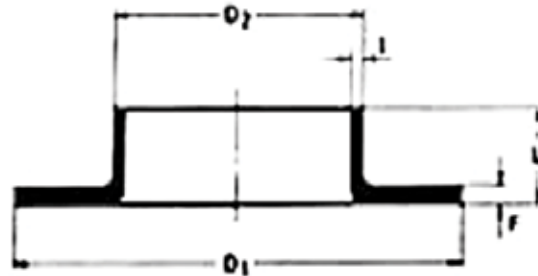

Collares Prensados

D2	F/t	D1	L	Peso
mm	mm (+/- 10%)	mm	mm (+2/-0)	kg/pce
21.3	2	45	6	0.040
21.3	3	45	8	0.060
26.9	2	58	7	0.070
26.9	3	58	8	0.090
33.7	2	68	9	0.100
33.7	3	68	10	0.140
42.4	2	78	10	0.130
42.4	3	78	12	0.210
48.3	2	88	10	0.160
48.3	3	88	15	0.220
60.3	2	102	12	0.200
60.3	3	102	13	0.260
88.9	2	138	13	0.350
88.9	3	138	14	0.450
114.3	2	158	13	0.390
114.3	3	158	14	0.530
141.3	2	188	14	0.650
141.3	3	188	15	0.830
168.3	2	212	18	0.570
168.3	3	212	19	0.840
219.1	2	268	22	0.670
219.1	3	268	23	0.670
273.0	3	320	23	1.260
323.9	3	370	24	1.750
406.0	3	482	24	4.000



Llave de Paso Esférica 2 Cuerpos

Equiv. en Pulgadas	Tamaño nominal	H	L	S
1/4"	11.6	46	54	92
3/8"	11.6	46	54	92
1/2"	15	49	64	92
3/4"	20	57	75	116
1"	25	66	87	143
1 1/4"	32	71	101	143
1 1/2"	38	81	110	177
2"	50	89	132	177



Válvula Bridada Esférica 2 Cuerpos

Equiv. en Pulgadas	Tamaño nominal	H	L	S
2"	50	115	178	218
2 1/2"	65	154	190	295
3"	80	160	203	295
4"	100	194	229	400
6"	150	274	394	550
8"	200	302	457	1000



Válvula Esférica 3 Cuerpos

Equiv. en Pulgadas	Tamaño nominal	H	L	S
1 1/4"	11.6	53	55	99
3/8"	11.6	53	55	99
1/2"	15	58.5	65	122
3/4"	20	62.5	75	122
1"	25	73.5	85	151
1 1/4"	32	79	100	151
1 1/2"	38	89	110	185
2"	50	98	130	185
2 1/2"	65	115	165	250
3"	76	125	188	250
4"	100	173	228	280